

TEMPERATURE SENSOR



T-123

Applications:

Temperature sensor for measurement in pressure receptacles pipelines and other industrial applications.

Technical Data

Measuring range	up to 600°C
Resistance element:	Pt100 up to PN-EN 60751+A2 Pt1000, Pt500
Protection tube material	stainless steel 1H18N9T (1.4541)
Connection line	2, 3 or 4 wire
Terminal head ambient temperature	100°C or 150°C
With transmitter	P - table of transmitters

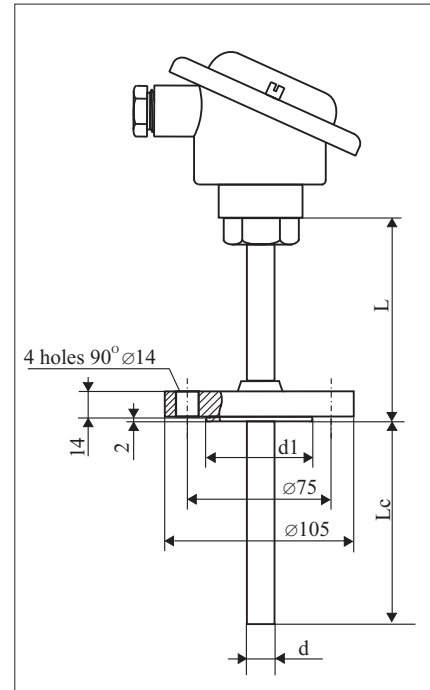

Ordering code

Transmitter	up to table	e.g. P1
Protection tube dia. d	Ø 12 mm	12
others		
Protection tube length Lc	200 mm	200
others		
Length L	100 mm	100
others		
Connection line	2-wire, 3-wire, 4-wire	e.g. 2
Inlet diameter d1	Ø 58 mm	58
Ø 56 mm (up to PN-ISO 7005-1)		
Terminal head type	B, NA	e.g. B
Tolerance	class - A, B	e.g. B
Measuring insert	Pt100, 2xPt100, others	e.g. Pt100
Operating temperature	80°C, 200°C, others	e.g. 200°C

Order example:

T-123-12-200-100-2-58-B-B-Pt100-200°C - sensor of protection tube diameter d=12 mm, length Lc=200 mm, length L=100 mm, 2-wire, inlet dia. d1=58 mm, terminal head B, class B, Pt100, operating temperature 200°C.